

Best Robotic Floor Cleaning Processes for Higher Education

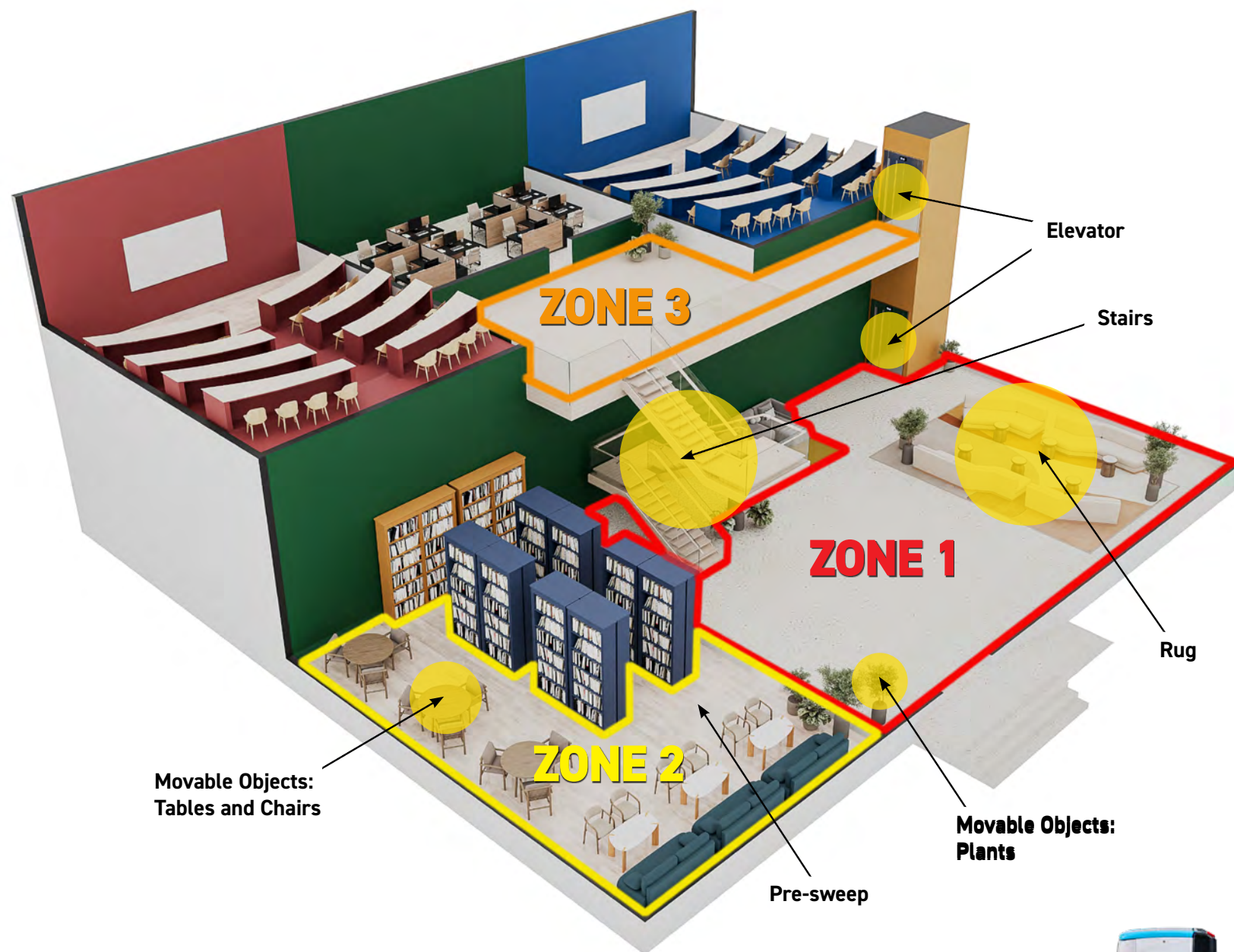

Zoning Best Practices:

Use this guide to help you utilize autonomous floor cleaning equipment in your higher education facility.

Pre-Sweep: Scan the area for items out of place and pre-sweep large debris.

Ramps: If a ramp in your space has more than a 2% incline, map spaces separately and run two routes.

Security or Emergency Doors: Robotic floor cleaners cannot go through doors, so it is important to map sections as separate zones.

Temporary and Moveable Objects (ex. tables, chairs, plants): Map around movable objects if there are protruding objects like a plant, map with enough space around it to not interfere with the robots route. Consider mapping a new route if there is a substantial change in the floor plan.

Rugs: When using a floor scrubber map around rugs/mats or consider mapping a secondary route for when rugs are moved.

Elevators, Escalators and Stairs: Leave a 2ft. distance when mapping near elevators or stairs.

Zones: We recommend splitting areas into zones. Zones may need to be split due to size (over 7,000 sq ft.), high traffic areas, multiple levels, or doors.

Multiple Floors: To increase cleaning efficiency, we recommend a second unit for multi-story buildings.

Cobi can run 3 x 7,000 sq. ft. routes in a 10-hour day. We recommend adding a unit to ensure optimal cleaning efficiency for any space over 21,000 sq. ft.

TIP



ABOUT ICE COBOTICS

ICE Robotics' is the leader in cleaning automation and technology. ICE Robotics' products like Cobi 18, an autonomous floor scrubber equipped with i-SYNERGY fleet management software, help healthcare facilities manage cleaning and optimize building performance. Learn more at us.icecobotics.com



ICE COBOTICS
icecobotics.com