

Best Processes for Cleaning Hospital Floors with Robotics Equipment

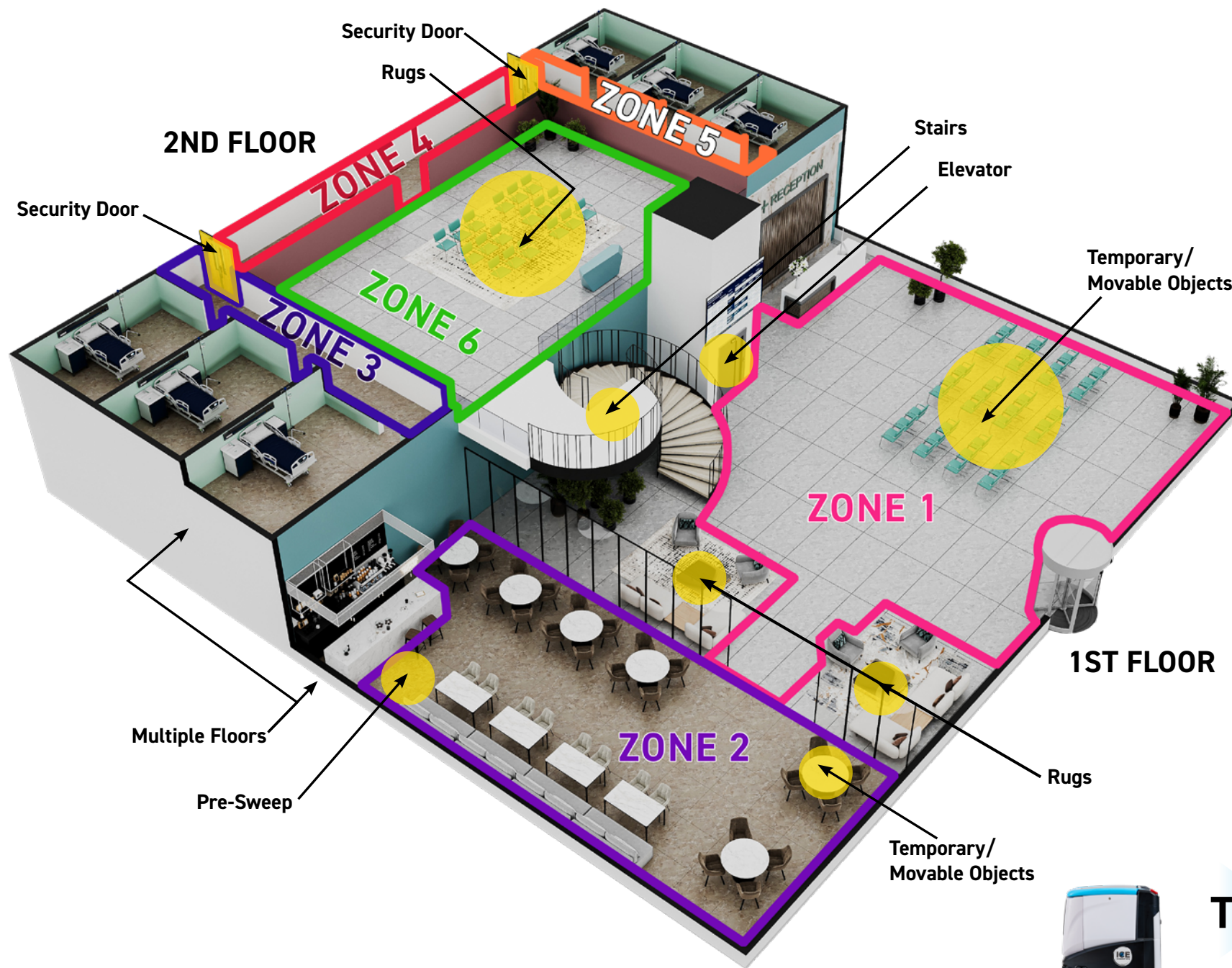

Zoning Best Practices:

Use this guide to help you utilize autonomous floor cleaning equipment in your facility.

Pre-Sweep: Scan the area for items out of place and pre-sweep large debris.

Ramps: If a ramp in your space has more than a 2% incline, map spaces separately and run two routes.

Security or Emergency Doors: Robotic scrubbers are not able to go through doors, it is important to map sections around doors as separate zones.

Temporary and Moveable Objects (ex. cafeteria plants): Map around movable objects. If there is a substantial change in the floor plan, consider mapping a new route.

Rugs: Map around rugs/mats or consider mapping a secondary route for when rugs are moved.

Elevators, Escalators and Stairs: Leave a 2ft. distance when mapping near elevators, escalators, or stairs.

Zones: We recommend adding high traffic areas to two zones, so the area is cleaned multiple times a day. Create a separate route near security doors and create new routes for anything over 7000 sq. ft.

Multiple Floors: To increase cleaning efficiency we recommend creating separate zones in each wing based on the amount of square footage on each floor.

TIP Cobi can run 3 x 7,000 sq ft routes in a 10-hour day. For any space over 21,000 sq ft, we recommend an additional unit to ensure optimal cleaning efficiency.

ABOUT ICE COBOTICS

ICE Cobotics' is the leader in cleaning automation and technology. ICE Cobotics' products like Cobi 18, an autonomous floor scrubber equipped with i-SYNERGY fleet management software, help healthcare facilities manage cleaning and optimize building performance. Learn more at [icecobotics.com](https://www.icecobotics.com)

CONTACT INFO

833-423-7626
clientcare@icecobotics.com
[icecobotics.com](https://www.icecobotics.com)

ICE COBOTICS®